

ES4

ECOLEAN PACKAGING SYSTEM



EL4 Filling machine



250 ml

200 ml

ES4 is an automatic straw applicator for the Ecolean® EL4 filling machine. ES4 is equipped with two applicator heads, eliminating the need of a space-consuming package buffer. The EL4+ES4 combination provides the filled packages transported out from the filling machine with straws for easy handling and consumption.

ES4

The ES4 straw applicator is designed for the EL4 filling machine.
ES4 is suitable for Ecolean® Air Aseptic package sizes 200 ml and 250 ml.

Type	Liquid food packages
Package sizes	200 ml and 250 ml
Capacity	10 000 packages/hour (200 ml) 10 000 packages/hour (250 ml)
Straw specification	Telescopic, total length 185 mm

ecolean
a lighter approach to packaging

TECHNICAL SPECIFICATIONS, ES4

Machine Model A-2550101

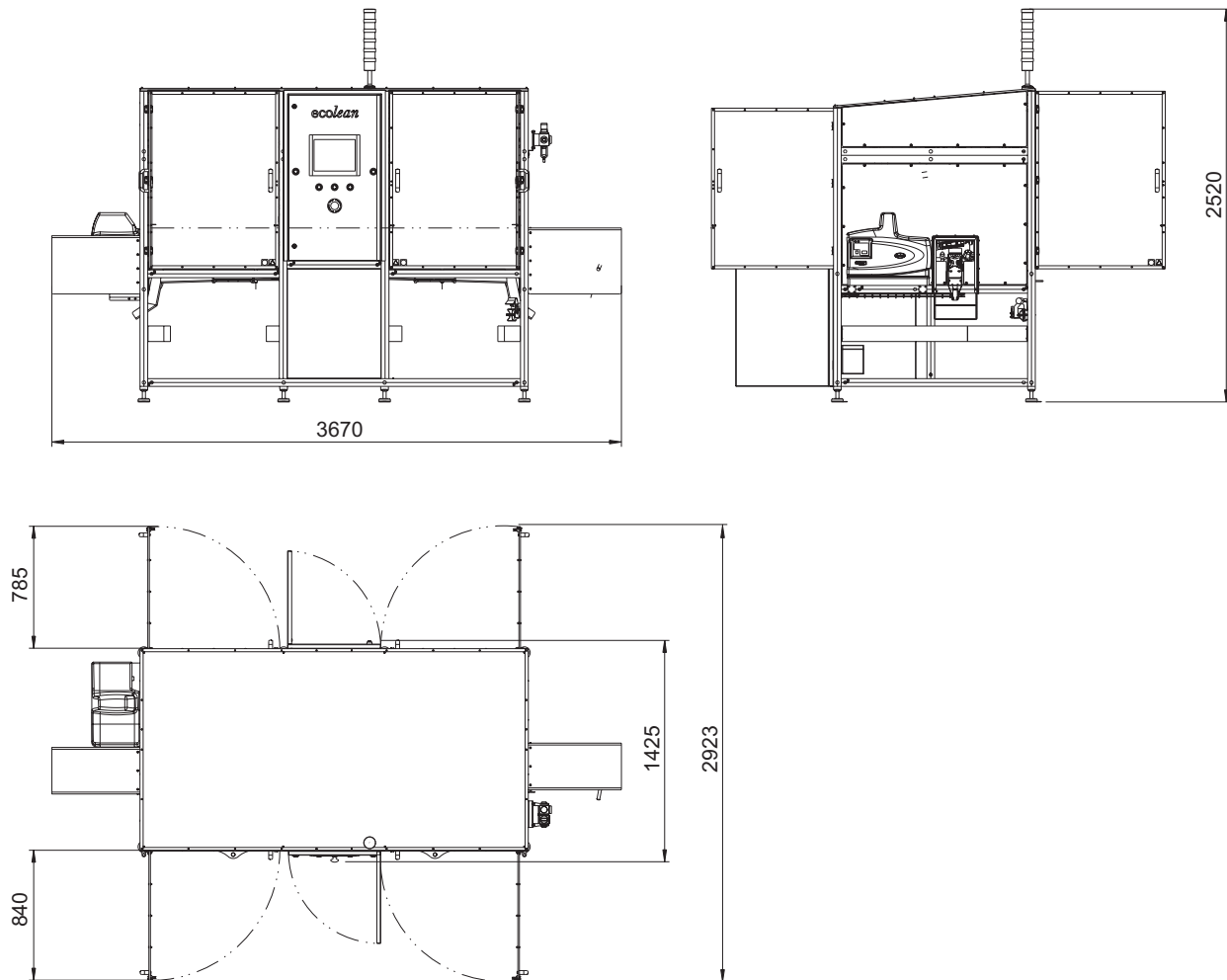

Power specifications

Main connection	400 V AC 50 Hz (L1, L2, L3, N, PE), 16 A
Power consumption	4 kW

Hot Melt specifications

Type	Henkel Technomelt Supra HT 325
Working temperature	165 °C (approx.)
Consumption	1 kg / 15 000 packages

Straw specifications

Type	Telescopic, total length 185 mm
Diameter	6 mm
Web width	117 mm
Pitch	15 mm

Packaging material

Type	Ecolean® Air Aseptic packages
Volume	200 ml and 250 ml

Capacity

10 000 packages/hour (200 ml)
10 000 packages/hour (250 ml)

Compressed air specifications

Connection	G ½ inch
Supply pressure	6-8 bar
Consumption	300 NI/min

Compressed air quality DIN ISO 8573-1

Operation temperature and humidity

The machine is designed to operate in a temperature range from +2 °C to +40 °C, and in a relative humidity range from 20 % to 80 %.

Machine intake

Length	3240 mm
Width	1685 mm
Height	2460 mm
Weight	1100 kg